

DIRECTIONS FOR LIGHTWEIGHT WOOD CAT SHELTER

Design adapted from Alley Cat Allies by
Cat Assistance Team of Central Ohio (www.catteam.org)

1. Cut all wood pieces to size according to diagram. Mark sides with marker or pencil to identify.
2. To create the bottom frame, stand the three 28" pieces and the two 21" pieces of pine on their sides and nail together using 1½ inch finish nails. See diagram below:

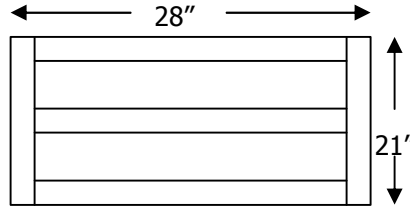

3. Place the Base onto the frame built in Step 2.
4. Nail the Base to the frame using 1½" finish nails to create the floor.
5. Set both side panels (Sides A and B) on the outside of the frame touching the ground and mark the height from the ground to the top of the floor on each panel. Make sure each side slants in same direction!

NOTE: From this point on, use 1" finish nails!

6. Take the two 9¾" pieces of pine and nail one to the inside of Side A and one to the inside of side B with the bottom of the pine on the line marked in Step 4 and flush to the 12" side. The pine pieces will be vertical to form the frame for the side panels. The top of the pine will be above the top of the plywood. Trim tops later with a handsaw.
7. Nail the two 15¼" pine pieces to the 18" sides of Sides A and B using the same directions in Step 5 (trim tops later).
8. After all sides are nailed, trim the tops of the pine pieces flush to the top of the plywood using a handsaw.
9. Place the sides onto the floor with the pine pieces facing inward and nail the sides to the base from the outside through the plywood. Make sure the sides are slanting in the same direction!
10. Nail the back into the base. Then nail the back to Sides A and B, making sure the nails go through the plywood into the pine frame.
11. Nail the front to the base and then to Sides A and B in the same manner.
12. Place the roof onto the structure and center it. Draw two lines onto the roof, outlining the front and back of the structure. Draw a line ¼" in toward the center of the roof from each of the original lines.
13. Center the two 27" pieces of pine on the inner lines so the pine is positioned toward the inside of the roof. Nail the pine pieces to the roof, so the roof fits snugly on the structure.
14. Prime entire structure (inside and out, including outside bottom of base) and paint with two coats of severe weather exterior paint. Do not try to put roof on until paint is completely dry!
15. Optional: adhere vinyl tile squares to inside floor of structure.
16. Fill with straw when paint is dry!

MATERIALS (makes one shelter)	EQUIPMENT
✓ 1½" finish nails (about 30)	✓ Power saw (if wood pieces are not pre-cut)
✓ 1" finish nails (about 50)	✓ Tape measure
✓ Primer (about 1 quart)	✓ Pencil to mark lines
✓ Paint (about 1 quart)	✓ Level or straight-edge to draw lines
✓ One: 4' x 8' sheet of ¼" plywood	✓ Hammer
✓ Three: 8-foot lengths of 1" x 1½" pine	✓ Hand saw
✓ Optional: 5 vinyl tiles squares for floor	✓ Angle brace or t-square
✓ Straw to fill	

WOOD AND CUTS FOR LIGHTWEIGHT FERAL CAT SHELTER

Design adapted from Alley Cat Allies by
Cat Assistance Team of Central Ohio (www.catteam.org)

Each shelter uses one 4' x 8' Sheet of 1/4" Plywood

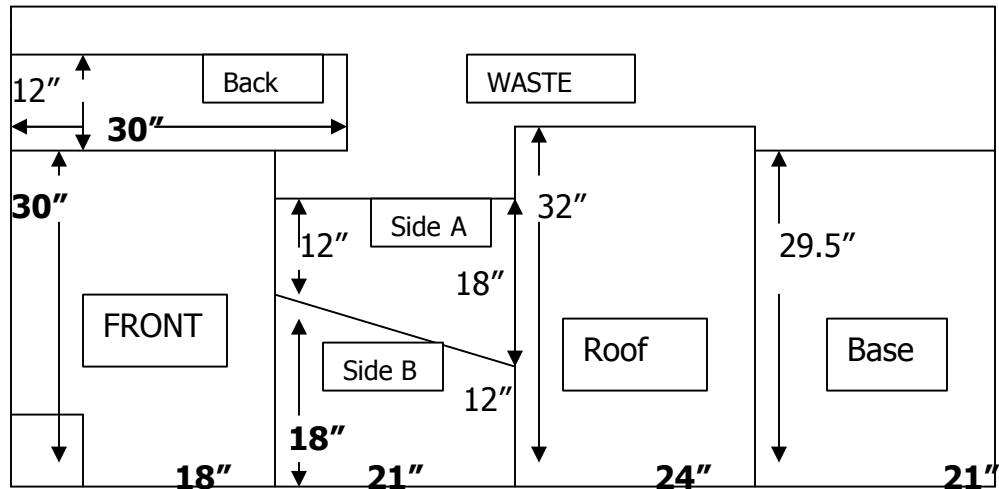

Note: cutout on front panel is 8" high x 6" wide for door
Note: this diagram is not to scale!

THREE PINE PIECES (8' lengths) 8' x 1" x 1 1/2"

- First piece: Cut three 28" lengths and one 9 3/4" length
- Second piece: Cut two 27" lengths and one 21" length
- Third piece: Cut one 21" length, two 15 1/4" lengths and one 9 3/4" length